

- NOTES:
- GENERAL NOTES:
1. ALL WORKS SHALL BE CONSTRUCTED IN ACCORDANCE WITH THE WORKS REQUIREMENTS.
 2. ALL DIMENSIONS IN METRES UNLESS SPECIFIED OTHERWISE.
 3. ALL CO-ORDINATES ARE TO IRISH TRANSVERSE MERCATOR.
 4. ALL LEVELS ARE TO ORDNANCE DATUM (MAIN HEAD).
 5. ALL TEMPORARY TRAFFIC & OPERATIONS MANAGEMENT SHALL COMPLY FULLY WITH THE WORKS REQUIREMENTS.
 6. THE CONTRACTOR MUST LAISE DIRECTLY WITH LOCAL AUTHORITY DEPARTMENTS AS DIRECTED IN THE WORKS REQUIREMENTS.
 7. ALL VEHICULAR & PEDESTRIAN, CYCLE & PRIVATE ACCESS ROUTES WITHIN AND SURROUNDING THE WORKS EXTENTS MUST BE MAINTAINED THROUGHOUT THE WORKS IN ACCORDANCE WITH THE CONTRACTORS APPROVED TEMPORARY TRAFFIC & OPERATIONS MANAGEMENT PLAN.
- DRAWING SPECIFIC NOTES:
1. ALL DRAWINGS TO BE CHECKED BY CONTRACTOR ON SITE AND ENGINEER INFORMED OF DISCREPANCIES BEFORE WORK COMMENCES.
 2. CONTRACTOR SHALL SATISFY HIMSELF AS TO THE ACCURACY OF EXISTING DRAINAGE LEVELS & SERVICES ON SITE PRIOR TO COMMENCEMENT OF WORKS ON SITE.
 3. ALL WORKS TO BE CONSTRUCTED IN ACCORDANCE WITH THE NRA SPECIFICATION FOR ROAD WORKS UNLESS NOTED OTHERWISE.
 4. MANHOLE COVER LEVELS ARE TO CONFORM WITH FINISHED ROAD AND PATH LEVELS.
 5. ALL DRAINAGE TO BE AS PER THE LOCAL AUTHORITY CODE OF PRACTICE FOR DRAINAGE WORKS/LOCAL AUTHORITY & IRISH WATER REQUIREMENTS.
 6. ALL EXTERNAL COLLECTOR DRAINS TO BE MINIMUM 150 mm DIA.
 7. ALL FOUL SEWERS TO BE uPVC TO EN1401.
 8. ALL SURFACE WATER SEWERS TO BE CLASS H CONCRETE TO EN1916 & IS 6 2004.
 9. CONTRACTOR SHALL INSPECT THE ROUTE & CONFIRM LOCATIONS OF ALL TREES, FEATURES, ENTRANCES & ASPECTS IMPACTING CONSTRUCTION OF THE WORKS.

- LEGEND:
- SITE BOUNDARY
 - PROPOSED SURFACE WATER
 - SW ATTENUATION TANK
 - EXISTING LEVELS
 - PROPOSED EXISTING LEVELS
 - PERMEABLE PAVEMENT
 - EXISTING SURFACE WATER

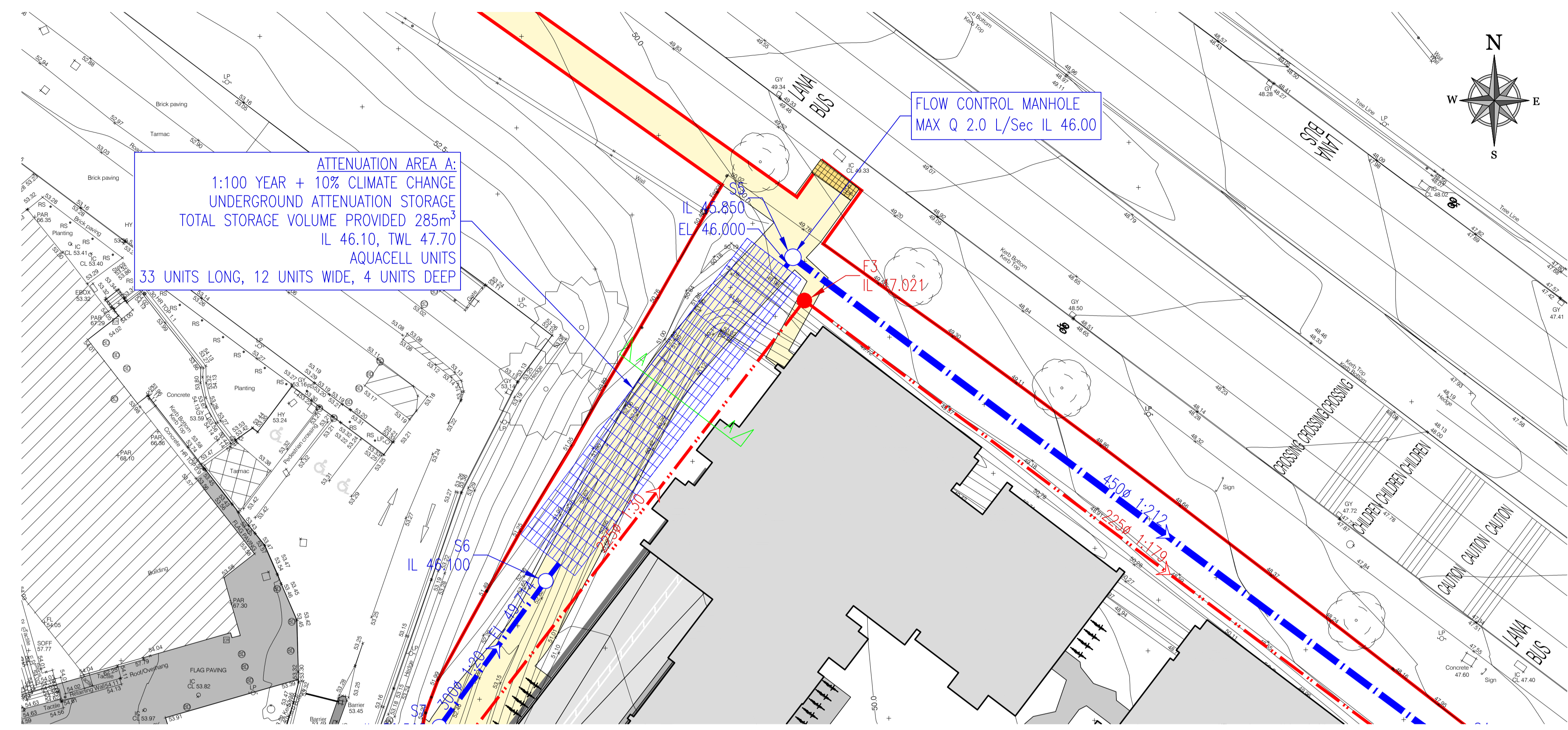

ATTENUATION AREA A:
 1:100 YEAR + 10% CLIMATE CHANGE
 UNDERGROUND ATTENUATION STORAGE
 TOTAL STORAGE VOLUME PROVIDED 285m³
 IL 46.10, TWL 47.70
 AQUACELL UNITS
 33 UNITS LONG, 12 UNITS WIDE, 4 UNITS DEEP

FLOW CONTROL MANHOLE
 MAX Q 2.0 L/Sec IL 46.00

PLAN OF ATTENUATION CATCHMENT AREA: A (SCALE 1:250)

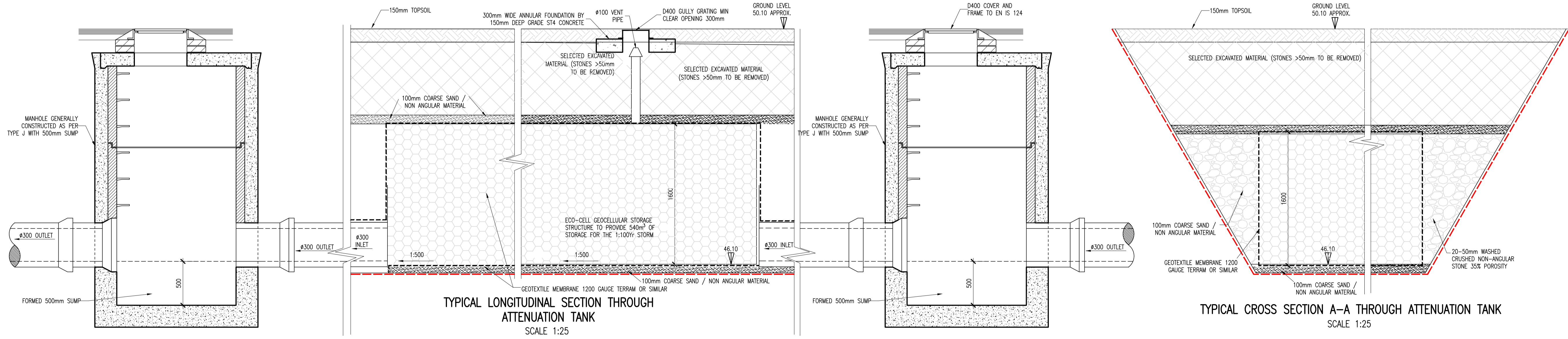

TYPICAL LONGITUDINAL SECTION THROUGH ATTENUATION TANK
 SCALE 1:25

TYPICAL CROSS SECTION A-A THROUGH ATTENUATION TANK
 SCALE 1:25

ORDNANCE SURVEY IRELAND LICENCE
 No EN 00177919
 © ORDNANCE SURVEY IRELAND
 GOVERNMENT OF IRELAND

REV	DATE	DESCRIPTION	BY	CHKD
P1	03-12-19	FOR ABP APPLICATION	JVS	BK

PLANNING

DESIGNED	SPB	PREPARED	JVS
DATE	OCT 2019	CHECKED	BK

DBFL Consulting Engineers
 Dublin Office: Ormond House, Upper Ormond Quay, Dublin 7, Ireland. PHONE +353 1 400 4000 FAX +353 1 400 4050
 Waterford Office: Unit 2, The Chandlery, 1-2 O'Connell Street, Waterford, Ireland. PHONE +353 51 309 5500 FAX +353 51 844 913
 Email: info@dbfl.ie www.dbfl.ie

PROJECT
PROPOSED DEVELOPMENT AT CORNELSCOURT

DRG. TITLE
TYPICAL ATTENUATION DETAILS FOR AREA A

CLIENT
CORNEL LIVING LIMITED

SCALE AS SHOWN @A1 FILE REF: 180208-DBFL-XX-XX-DR-C-3014
 DRG. NO. 180208-DBFL-XX-XX-DR-C-3014 P1